



Double Door - Not Divided Full or Half Depth Shelf Pantry Worksheet

Uses 4 "L" Bracket Installation On Base Shelves & 2 "RB" Bracket Installation For Non-Base Shelves

The full and half depth shelf type pantry will use:

- 4 "L" bracket method of installation for both the lower base and upper base shelves
- 2 "RB" bracket method for the non-base shelves

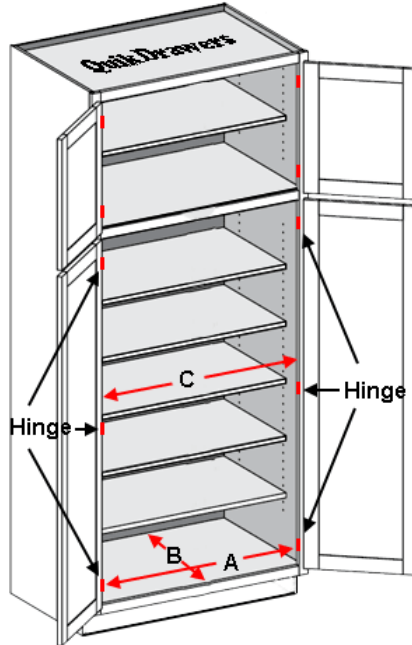

2 rear bracket installation for all non-base, half depth shelves

4 "L" bracket installation for all full depth shelves, including the top and bottom base shelves

A - From hinge to hinge (if present), otherwise from side of frame opening to opposite side of frame opening
 B - From rear wall to inside of face frame
 C - From side of frame opening to opposite side of frame opening, should be area clear of hinges

- A** Record the measurement from hinge to opposite side of opening. If there is no hinge, then measure from side of opening to opposite side of opening.
- B** Record the measure from the rear wall to the inside edge of the front face frame
- C** Record the distance from one side of the opening to the opposite side of the opening. The upper shelf area should be clear of any hinges

<u>Cabinet #</u>	<u>"A"</u>	<u>"B"</u>	<u>"C"</u>
_____	_____	_____	_____
_____	_____	_____	_____
_____	_____	_____	_____
_____	_____	_____	_____
_____	_____	_____	_____