

NEW PRODUCT !

T-803 Institutional Shelf Support

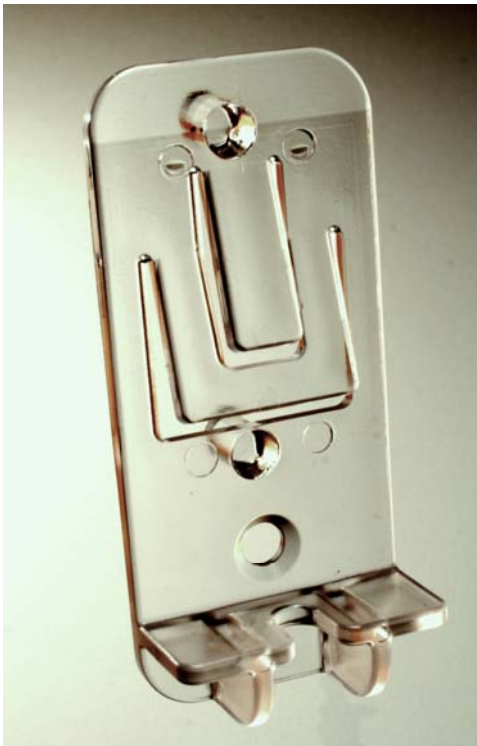

- Passes 300 pound shear test
- Shelf loads of over 500 pounds
- For all heavy-duty applications
- Ideal for Commercial or Institutional Furniture
- Locks in 3/4" or 1" shelves
- Twin 5mm pins
- Made from ultra strong, clear polycarbonate
- Can be screwed to side panel for added security
- Shelf can be screwed to shelf support

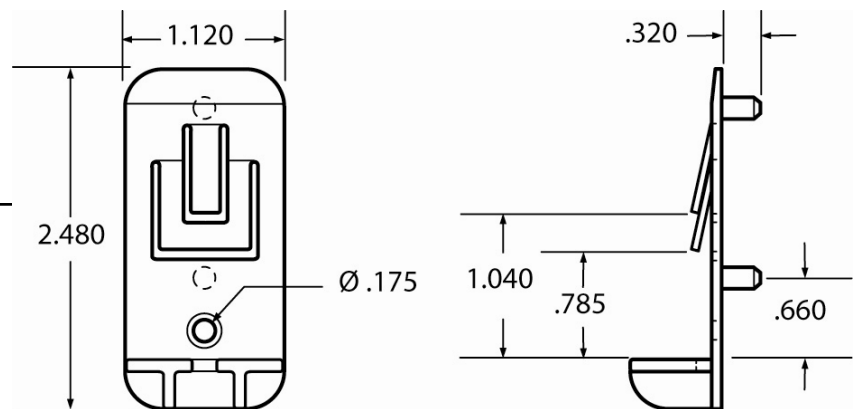

Order Information:

BULK: T-803 (1000/box):
POLYBAG: B-403 (100/bag)

8011 National Service Road
P.O. Box 550
Colfax, NC 27235
1-800-TENN-TEX
www.tenntex.com

The home of the QuikTRAY™

T-803

Shelf Drop Test—100 pound shelf weight

Property of TENN-TEX Plastics, Inc

4 lb. weight was dropped from 5” height as per the ANSI/BHMA A156.9-03 Grade 3 requirement and Static Load Test BHMA section 4.8.4.3 and Impact Load Test BHMA section 4.8.4.4.



4.8.3 Grade 3 Test Conditions

4.8.3.1 Two parallel vertical walls, or simulated walls, with approximately $\frac{3}{4}$ in. (19 mm) thick soft wood (pine) facing, shall be spaced approximately 24 in. (610 mm) apart.

4.8.3.2 Two holes shall be symmetrically and horizontally spaced 6 in. \pm $\frac{1}{16}$ in. (152 mm \pm 1.6 mm) apart on each wall. The hole size shall be that recommended by the manufacturer in the printed instructions or lacking this instruction it shall be the nearest $\frac{1}{64}$ in. diameter (standard metric drill size) larger than the minor or basic diameter of the post.

4.8.3.3 A shelf rest shall be inserted in each of the four holes.

4.8.4 Common Test Conditions

4.8.4.1 A $\frac{3}{4}$ in. x 8 in. (19 x 203 mm) all \pm (1.6 mm) wide by approximately 24 in. (610 mm) long plywood shelf shall be placed on the rests and the length of the shelf shall be adjusted so that there is not more than $\frac{3}{32}$ in. (2.4 mm), or less than $\frac{1}{32}$ in. (0.8 mm) clearance between the ends of the shelf and the standards and clearance shall be equal at both ends.

4.8.4.2 A $1\frac{1}{2}$ in. x $5\frac{1}{2}$ in. x $11\frac{1}{2}$ in. (38 x 140 x 292 mm) all \pm $\frac{1}{8}$ in. (3 mm) wood plate shall be centrally placed on the shelf to minimize its deflection.

4.8.4.3 The specified static load shall be gradually applied at the center of the shelf.

4.8.4.4 After the static load has been on the shelf five minutes, and without removing this load, a 20 in.-lbf (2.3 J) impact load shall be applied at the center of the shelf by dropping a 4 lb. (1.8 kg) weight 5 in. (127 mm).

Product Code	Static Load
1	500 lbf (2220 N)
3	100 (lbf (444 N)

TENN-TEX
PLASTICS INC.

T-803 Weight Test

Property of TENN-TEX Plastics, Inc.



T-803 Shear Test

For Shelves up to 300 pounds

Property of TENN-TEX Plastics, Inc.



T-803 Shear Test

